

Energy efficient , beautiful environment



COMPANY INTRODUCTION

Shenzhen K-Easy Automation Co.,Limited is a professional manufacturer, specialize in R&D And production of AC drives. We have built up a comprehensive product family. Frequency inverters' power covers the range from 0.4 to 630kW, and voltage range is between 220V and 480V. More than inverters are running smoothly 300,000 units at different industrial sites.

Why Us

- ◆ We believe "quality is life" ,so we will test all products before shipment,All Module of our VFD will be used quality is life with Infineon only, With years of persistence, the total failure ratio of Our frequency inverters has been controlled below 1%. We never lose a customer because of the quality problem;
- ◆ With Strong R&D and Engineer Team, makes our after-service very easy, For all doubts and requesting for technologies supporting, We can offer detailed Solution without delay, so for us, "Not Only Products, But also solutions" ;
- ◆ All our products will be offered with 24 months Warranty Period instead of 18 months.

Join us, enjoy the business.



SHENZHEN K-EASY AUTOMATION CO.,LIMITED

Room 301, No. 13, Tangxi Xijing Industrial Zone, Gushu Community, Xixiang Street, Bao' an District, Shenzhen

Tel: +86-0755-27850411

Wechat: +86-19924552818

Whats App: +86-13332991978

E-mail: Sales@keasyautomation.com

Http: //www.keasyautomation.com



Version: A01



CE100 Series
Variable frequency drive for Freight construction elevators

CE200 Series
Man-cargo elevator special inverter



CE100 Series



HIGH INTEGRATION



HIGH CONTROL PRECISION

CE100 series variable frequency driver is a special model developed for the electronic control of cargo construction lifts. The system integrates the functions of frequency converter, wireless video surveillance, wireless voice intercom, wireless remote control, logic control unit, brake control unit and weight limiter in one, and can choose three installation methods: wall hanging, semi-embedded and fully embedded. It has the advantages of comprehensive functions, stable performance, beautiful appearance, easy installation and maintenance, and provides customers with a set of high-performance and complete solutions.



PRODUCT ADVANTAGE

01 Wireless video surveillance

For the first time in the industry, fisheye camera is used, and there is no dead Angle in the elevator cage monitoring;

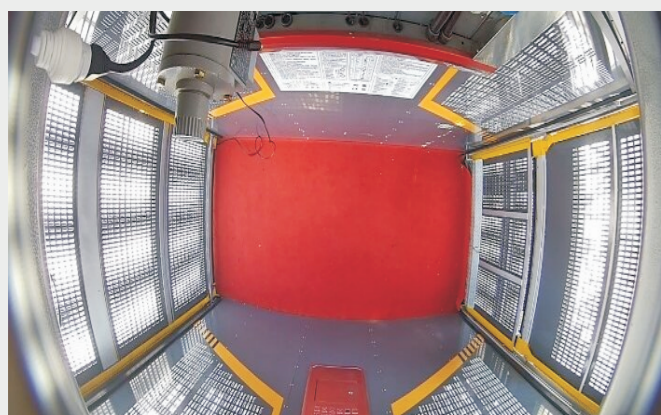

02 Automatic leveling function

Reduce the work intensity of the operator driver, automatically run in place after entering the floor, and the level position is accurate (<math>< 5\text{mm}</math>);

03 Floor caller control function

After meeting the operating conditions of the lift, press the floor caller of the corresponding floor, the lift will automatically run to the floor, the worker will close the discharge door after handling things, press the floor caller of the floor, the lift will automatically run to the first floor.





COMPLETE SYSTEM COMPOSITION



PRODUCT PARAMETER

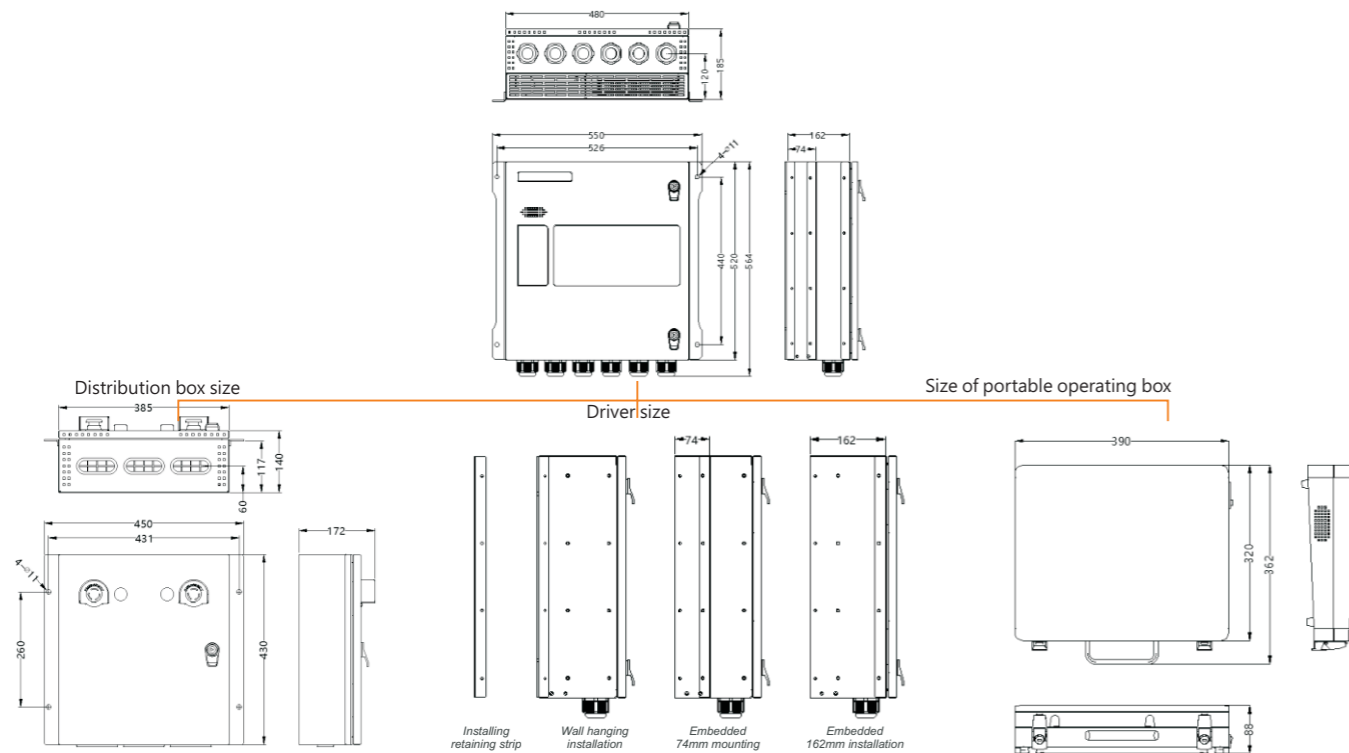

CE200 Series



HIGH INTEGRATION



HIGH CONTROL PRECISION

CE200 series variable frequency driver is a special model developed for the electric control of construction lifts. The system integrates the functions of frequency converter, brake unit, logic control unit, brake control unit and weight limiter in one, and can choose three installation methods: wall hanging, semi-embedded and fully embedded, with comprehensive functions, stable performance, beautiful appearance, easy installation and maintenance. To provide customers with a set of high-performance, complete solutions.



PRODUCT ADVANTAGE

01

Rich door panel display

Operating frequency and load information are displayed in real time on the door panel, and all limit, handle input and brake output status are prompted by separate indicators;

02

Rich voice function

Voice broadcast content is rich, common faults have a separate voice prompt, combined with the door panel display information, greatly improve the efficiency of on-site fault diagnosis;

03

Brake resistance short circuit protection

Built-in brake unit with brake resistance short-circuit protection function;

04

Brake coil short circuit protection function

Real-time monitoring of the brake coil current value, abnormal situation immediately cut off the input, protect the brake coil and internal devices;

PRODUCT ADVANTAGE

05 Man-machine interface function

The interface display is optimized and upgraded, using pictures instead of text description, and adding fault recording function interface;

06 Automatic leveling function

Reduce the work intensity of the operator driver, automatically run in place after entering the floor, and the level position is accurate (<5mm).

08 Dedicated lock control logic

Through the release current, release frequency, release delay time and so on, the special lock control logic is realized to ensure the safe and reliable operation of the lift.

07 Pre-authorization function

The built-in perpetual calendar clock can be set for three periods of device authorization time, and each of the three periods can be set independent passwords, which is convenient for users to manage the installment payment of the device.



The door panel screen is displayed

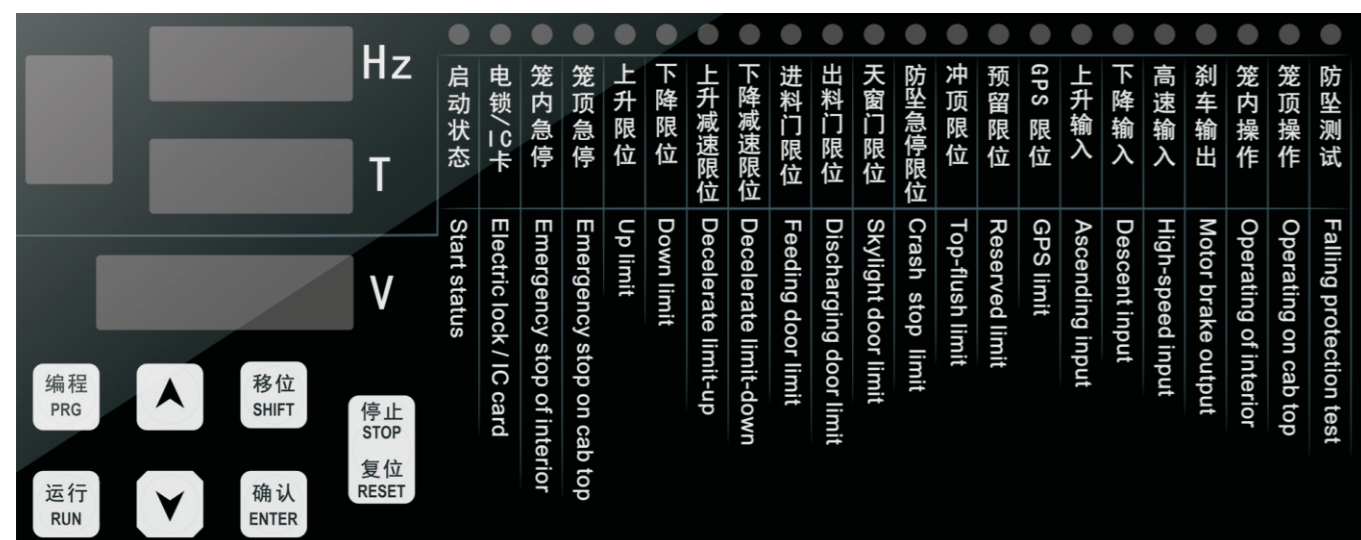

COMPLETE SYSTEM COMPOSITION

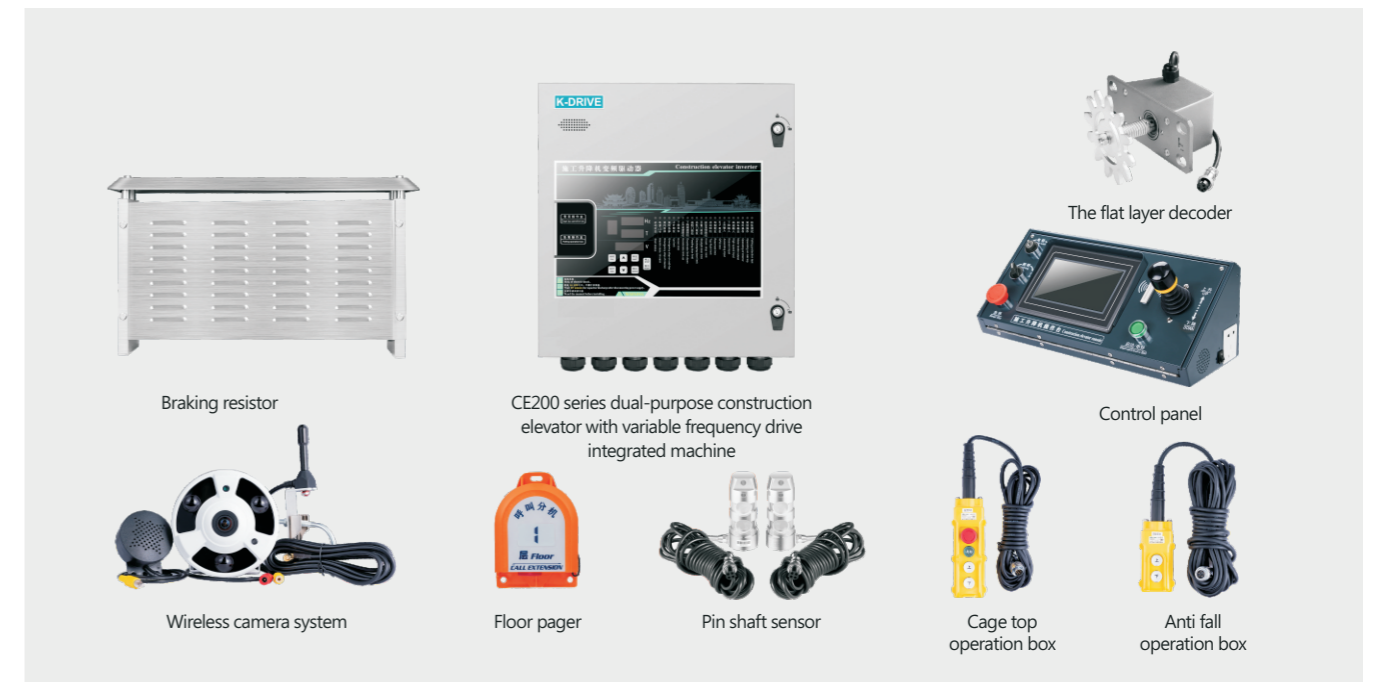

PRODUCT PARAMETER

